

Turn off the water supply, flush the toilet to empty the tank.

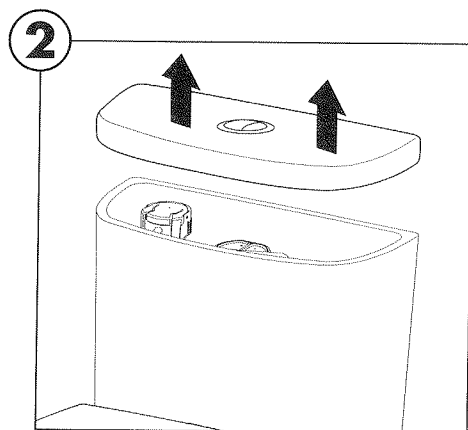

Remove the tank lid.

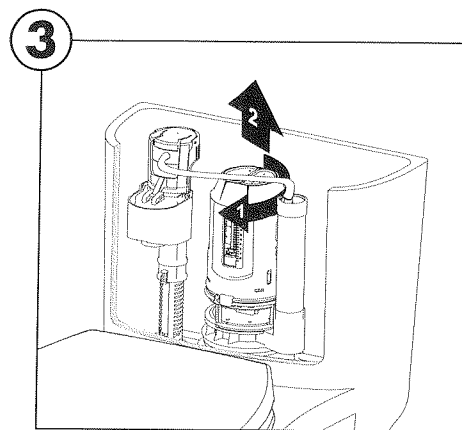

Turn the canister clockwise and lift up to remove.

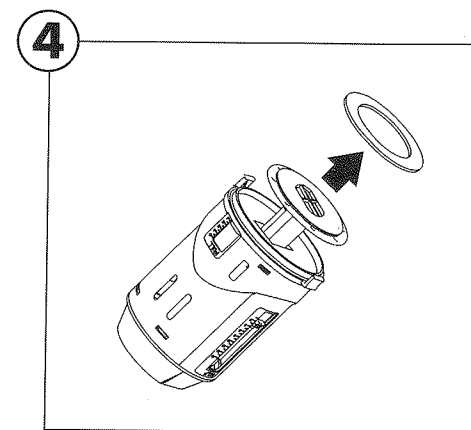

Locate the old seal at the bottom of the canister and peel it off.

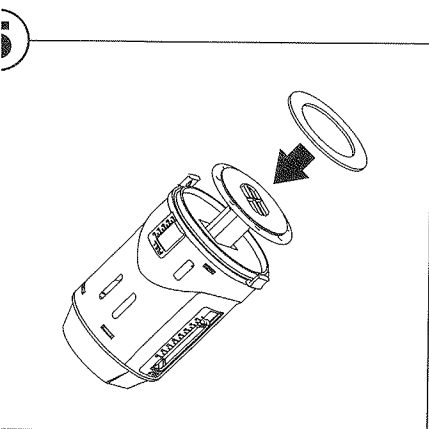

Install the replacement seal.

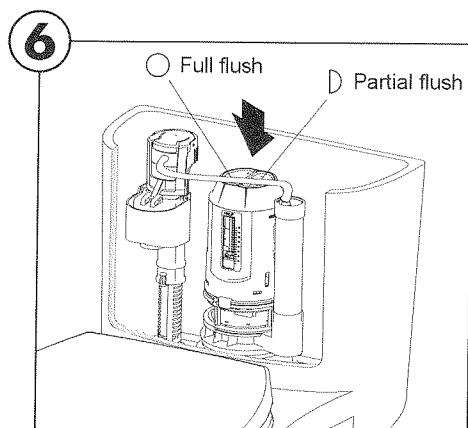

Insert the canister into the base and make minor direction adjustment.

**Caution:** "○" full flush, "D" partial flush  
Pls ensure "○" align to full flush button and "D" to partial flush button of tank lid.

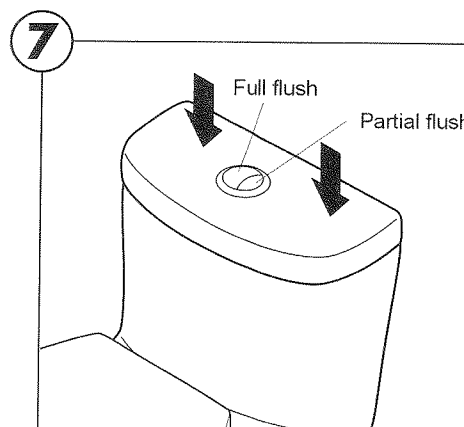

Put the tank lid back on.

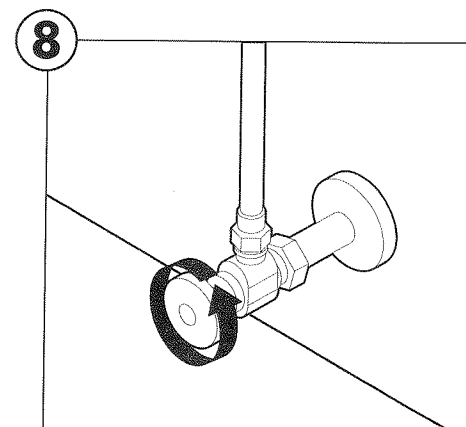

Turn on the water supply.